

ONLY FOR INFORMATION, NOT FOR MANUFACTURING

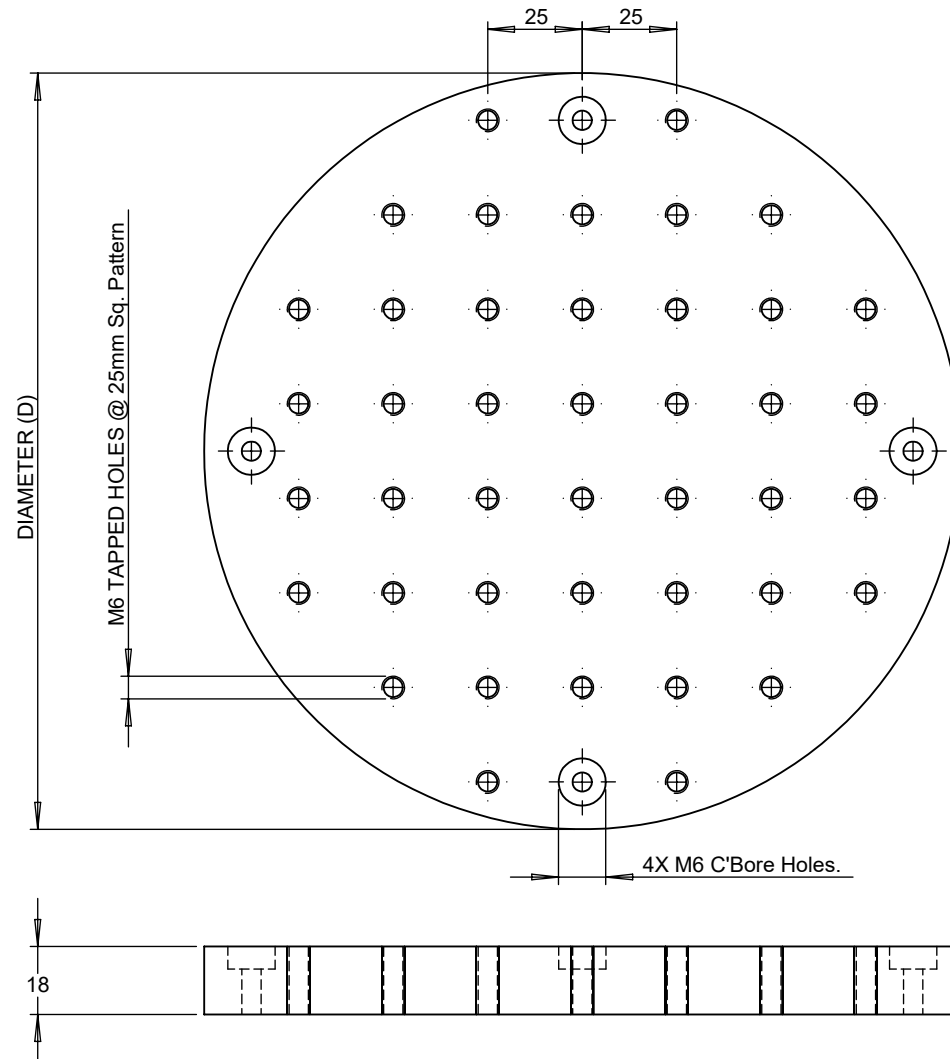

MODEL NUMBER	DIA (in mm)
HSB250	250
HSB300	300
HSB350	350
HSB400	400
HSB500	500
HSB600	600
HSB750	750

All Dimensions are in mm

DRAWN	VIJAY	SCALE	NA
CHECKED	N	REVISION	R-0
APPROVED	DRK	PAGE SIZE	A4
DATE	12-07-2021	SHEET NO.	01 OF 01
MODEL/DWG NO :			
OAE-HSB-CIR.SERIES			

TITLE : HDS CIRCULAR BREADBOARD

**Optica**

OPTICS & ALLIED ENGINEERING PVT.LTD  
 WWW.OPTICSINDIA.COM INFO@OPTICSINDIA.COM

PROPRIETARY AND CONFIDENTIAL. THE INFORMATION CONTAINED IN THIS DRAWING IS THE SOLE PROPERTY OF OPTICS & ALLIED ENGINEERING PVT.LTD. ANY PRODUCTION IN PART OR AS A WHOLE WITHOUT THE WRITTEN PERMISSION OF OPTICS & ALLIED ENGINEERING. IS STRICTLY PROHIBITED.

**SPECIFICATIONS:**

- Material of Construction - Aluminium Alloy.
- 18mm Thick Solid Aluminium Plate.
- M6 Tapped Holes @ 25mm Grid.
- M6 C'bore Hole for Base Mounting.
- Anodized finish - Black Matte.
- Custom Shapes And Sizes Available Upon Request.
- Other Size Tapped Holes & Double Density Series Are Available.